



Cuscinetti a rulli conici, serie metriche ed in pollici

Tapered roller bearings, metric series and inches series



CUSCINETTI A RULLI CONICI

I cuscinetti ISB ad una corona di rulli conici hanno piste coniche sia sull'anello interno che su quello esterno con interposizione di rulli conici (**Fig. 1**). La forma costruttiva dei cuscinetti ISB ad una corona di rulli conici li rende particolarmente adatti a reggere carichi combinati radiali ed assiali. I cuscinetti a rulli conici sono scomponibili in quanto l'anello interno, con il gruppo rulli e la gabbia, forma un'unità che può essere montata indipendentemente dall'anello esterno; è tuttavia fondamentale segnalare che, pur essendo scomponibili, le coppie coppa-cono costituiscono un'unità non interscambiabile motivo per cui, durante le fasi di installazione, è necessario garantire che non vengano accoppiate coppe e coni appartenenti a cuscinetti differenti.

TAPERED ROLLER BEARINGS

ISB single row tapered roller bearings have tapered raceways on both the inner and outer rings, with interposition of tapered rollers (**Fig. 1**). The construction shape of ISB single row tapered roller bearings makes them particularly suitable for supporting combined radial and axial loads. The tapered roller bearings can be dismantled as the inner ring, with the roller assembly and the cage, forms a unit that can be mounted independently of the outer ring; however, it is essential to point out that, despite being separable, the cup-cone pairs constitute a non-interchangeable unit: therefore, during the installation phases, it is necessary to ensure that cups and cones belonging to different bearings are not coupled.

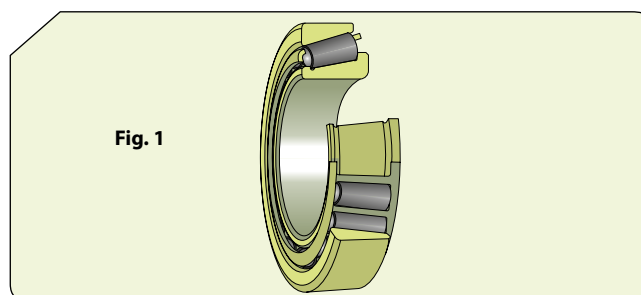

Cuscinetti ad una corona di rulli conici appaiati

Nei sistemi in cui la capacità di carico di un solo cuscinetto a rulli conici non è sufficiente oppure quando l'albero deve essere vincolato assialmente in entrambe le direzioni con un dato giuoco assiale positivo o negativo, si possono impiegare i cuscinetti descritti nella sezione "Cuscinetti ad una corona di rulli conici" disponibili come coppie appaiate (**Fig. 2**) e disposti ad "X".

Matched single row tapered roller bearings

In systems where the load carrying capacity of a single tapered roller bearing is not sufficient, or when the shaft must be axially constrained in both directions with a given positive or negative axial clearance, the bearings described in the section "single-row tapered roller bearings" can be used, available as matched pairs (**Fig. 2**) and arranged in an "X" shape.

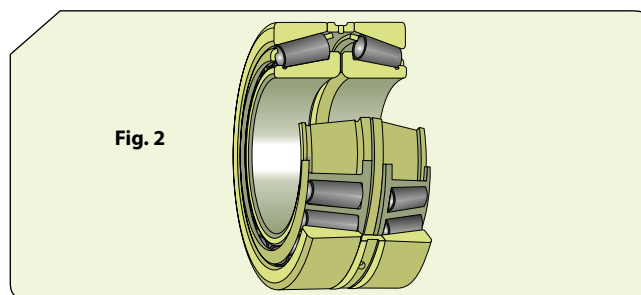

I gruppi appaiati rappresentano una soluzione economica per risolvere molti problemi ed offrono diversi vantaggi:

- montaggio semplificato;
- posizionamento esatto dell'albero in senso assiale;
- elevata capacità di carico assiale e radiale;
- manutenzione semplificata; in questo caso il lubrificante può essere introdotto attraverso la scanalatura anulare ed i fori di lubrificazione del distanziale intermedio.

Paired groups represent an economical solution to solve many problems and offer several advantages:

- simplified assembly;
- exact positioning of the shaft in the axial direction;
- high axial and radial load capacity;
- simplified maintenance; in this case, the lubricant can be introduced through the annular groove and the lubrication holes of the intermediate spacer.

Dimensionamento

Le dimensioni d'ingombro dei cuscinetti ISB ad una corona di rulli conici metrici sono conformi alla ISO 355. I cuscinetti ISB ad una corona di rulli conici in pollici seguono le norme ANSI/ABMA 19.2.

Dimensions

The overall dimensions of ISB single-row metric tapered roller bearings comply with ISO 355 standard. ISB single row inch tapered roller bearings follow ANSI / ABMA 19.2 standards.

Tolleranze

I cuscinetti ISB ad una corona di rulli conici, sia metrici che in pollici, vengono realizzati nella classe di precisione normale o ABEC 3-P6, identificata mediante il brand ISB-EMS.

Gabbie

I cuscinetti ISB ad una corona di rulli conici hanno una gabbia in lamiera stampata d'acciaio (**Fig. 3a**) e possono essere impiegati fino ad una temperatura di esercizio pari a + 120°C.

Tolerances

ISB single-row tapered roller bearings, both metric and inches, are manufactured in the normal precision class or in ABEC 3-P6 class, corresponding to the ISB-EMS brand.

Cages

ISB single row tapered roller bearings have a pressed steel sheet cage (**Fig. 3a**) and can be used up to an operating temperature of + 120 °C.

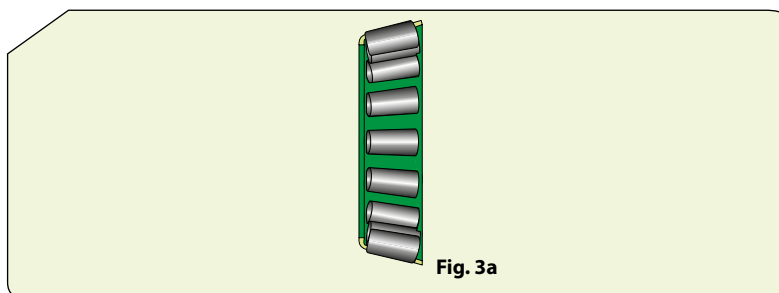

Fig. 3a

Carico minimo

I cuscinetti ISB ad una corona di rulli conici devono essere soggetti ad un certo carico minimo soprattutto se ruotano a velocità elevate. In questo caso le forze d'inerzia dei rulli e delle gabbie, nonché l'attrito del lubrificante, possono influire negativamente sulle condizioni di rotolamento all'interno del cuscinetto e possono provocare degli strisciamenti dannosi tra i rulli e le piste. Per un funzionamento senza slittamenti occorre quindi prevedere un carico radiale minimo dell'ordine di grandezza di $C/Pr > 0,01$.

Appellativi supplementari

I suffissi nella designazione dei prodotti vengono utilizzati per identificare alcune caratteristiche aggiuntive dei cuscinetti a rulli conici ISB e sono i seguenti:

B	Angolo di contatto maggiore di quello di esecuzione standard
DF	Cuscinetti appaiati disposti ad "X"
J	Gabbia stampata in lamiera d'acciaio del tipo a feritoie, centrata sui rulli. La cifra che eventualmente segue J indica un'esecuzione diversa della gabbia
P6	Precisione dimensionale e di rotazione secondo la classe di tolleranza 6 della norma ISO
TN9	Gabbia stampata ad iniezione in poliammide 6,6 rinforzata con fibre di vetro
X	Dimensioni d'ingombro modificate per essere conformi alle norme ISO

Minimum load

ISB single row tapered roller bearings must be subjected to a certain minimum load especially if they rotate at high speeds. In this case, the inertia forces of the rollers and cages, as well as the friction of the lubricant, can adversely affect the rolling conditions inside the bearing and can cause damaging sliding between the rollers and the raceways. Therefore, for operation without slippage, it is necessary to provide for a minimum radial load of $C/Pr > 0.01$ approx.

Additional suffixes

The suffixes in the product designation are used to identify some additional features of ISB tapered roller bearings and are as follows:

B	Contact angle greater than in standard execution
DF	Paired bearings, "X" arrangement
J	Molded steel sheet cage, slot-type, centered on the rollers. The number eventually following J indicates a different cage execution
P6	Dimensional and rotation accuracy according to tolerance class 6 of the ISO standard
TN9	Injection molded cage in polyamide 6.6, reinforced with glass fibers
X	Overall dimensions modified to comply with ISO standards

CUSCINETTI AD UNA CORONA DI RULLI CONICI (serie metrica)
TAPERED ROLLER BEARINGS, SINGLE ROW (metric series)



Dimensioni (mm) Dimension (mm)					Coefficiente di carico (KN) Load rating (KN)		Velocità limite (giri/min) Speed limit (Rpm)		Peso (Kg) Weight (Kg)	Sigla Designation
d (mm)	D (mm)	T (mm)	B (mm)	A (mm)	Dinamico Dynamic C	Statico Static C ₀	Lubrificazione Lubrication			
							Grasso Grease	Olio Oil		
15	42	14.25	13	11	26.6	19.8	13770	16200	0.095	30302
17	40	13.25	12	11	23.2	18.5	13770	16200	0.075	30203
	47	15.25	14	12	34	24.8	12240	14400	0.13	30303
	47	20.25	19	16	42.7	33.4	12240	14400	0.17	32303
20	42	15	15	12	29.5	26.8	12240	14400	0.097	32004
	47	15.25	14	12	34	27.9	11475	13500	0.12	30204
	52	16.25	15	13	41.7	32.3	10710	12600	0.17	30304
	52	16.25	15	11	28.5	27.5	10710	12600	0.17	31304
	47	19.25	18	15	33.2	35	8500	11000	0.15	32204
	52	22.25	21	18	54.1	45.3	10710	12600	0.23	32304
22	44	15	15	11.5	30.8	28.8	11475	13500	0.1	320/22
25	47	15	15	11.5	33.1	32.4	10710	12600	0.11	32005
	52	16.25	15	13	38	33.3	9945	11700	0.15	30205
	52	19.25	18	15	44.4	43.8	9945	11700	0.19	32205
	52	19.25	18	16	44.4	43.8	9945	11700	0.19	32205-A
	52	22	22	18	57.5	55.8	9945	11700	0.23	33205
	62	18.25	17	15	55.1	42.9	9180	10800	0.26	30305
	62	18.25	17	13	46.4	39.8	8415	9900	0.26	31305
	62	25.25	24	20	73.8	62.8	9180	10800	0.36	32305
28	52	16	16	12	38.8	37.8	9945	11700	0.15	320/28
	58	17.25	16	14	46.4	41.4	9180	10800	0.25	302/28
	58	20.25	19	16	51.7	50	9180	10800	0.25	322/28
30	55	17	17	13	43.7	43.9	9180	10800	0.17	32006
	62	17.25	16	14	50	43.8	8415	9900	0.23	30206
	62	21.25	20	17	61.6	56.9	8415	9900	0.28	32206
	62	25	25	19.5	79.5	76.4	8415	9900	0.37	33206
	72	20.75	19	16	69	55.8	7650	9000	0.39	30306
	72	20.75	19	14	58.1	49.8	7268	8550	0.39	31306
	72	28.75	27	23	94.9	84.8	7650	9000	0.55	32306
32	58	17	17	13	44.9	46.4	8415	9900	0.19	320/32
35	62	18	18	14	52.1	53.9	8415	9900	0.22	32007
	72	18.25	17	15	63.1	55.8	5300	7100	0.32	30207
	72	24.25	23	19	81	77.9	7268	8550	0.43	32207
	72	28	28	22	103.6	105.8	7268	8550	0.56	33207
	80	22.75	21	18	88.8	73.3	6885	8100	0.52	30307
	80	22.75	21	15	75.2	66.8	6503	7650	0.52	31307
	80	32.75	31	25	115	114	6885	8100	0.73	32307
40	68	19	19	14.5	64.6	70.9	7268	8550	0.27	32008
	75	26	26	20.5	97.3	103.7	6885	8100	0.51	33108
	80	19.75	18	16	75.6	67.8	6503	7650	0.42	30208
	80	24.75	23	19	91.5	86.3	6503	7650	0.53	32208
	80	32	32	25	127.7	131.8	6503	7650	0.77	33208
	90	25.25	23	20	105.8	94.8	6120	7200	0.72	30308

CUSCINETTI AD UNA CORONA DI RULLI CONICI (serie metrica)
TAPERED ROLLER BEARINGS, SINGLE ROW (metric series)



Dimensioni (mm) Dimension (mm)					Coefficiente di carico (KN) Load rating (KN)		Velocità limite (giri/min) Speed limit (Rpm)		Peso (Kg) Weight (Kg)	Sigla Designation
d (mm)	D (mm)	T (mm)	B (mm)	A (mm)	Dinamico Dynamic C	Statico Static C ₀	Lubrificazione Lubrication			
							Grasso Grease	Olio Oil		
40	90	25.25	23	17	91	81.3	5738	6750	0.72	31308
	90	35.25	33	27	142.2	139.5	6120	7200	1	32308
45	75	20	20	15.5	71.5	79.7	6503	7650	0.34	32009
	80	26	26	20.5	103.6	113.5	6120	7200	0.56	33109
	85	20.75	19	16	81.4	76.3	6120	7200	0.48	30209
	85	24.75	23	19	98.5	97.8	6120	7200	0.58	32209
	85	32	32	25	131.6	142.6	5738	6750	0.82	33209
	100	27.25	25	22	131.7	119.8	5355	6300	0.97	30309
	100	27.25	25	18	112.6	101.5	5126	6030	0.95	31309
100	38.25	36	30	172.1	169.5	5355	6300	1.35	32309	
50	80	20	20	15.5	74.9	87.7	6120	7200	0.37	32010
	80	24	24	19	84.5	101.7	6120	7200	0.45	33010
	85	26	26	20	105.6	121.4	5738	6750	0.59	33110
	90	21.75	20	17	92.9	91.1	5738	6750	0.54	30210
	90	24.75	23	19	100.6	99.5	5738	6750	0.61	32210
	90	32	32	24.5	141.5	159.4	3800	5000	0.9	33210
	110	29.25	27	23	153.2	139.9	4820	5670	1.25	30310
	110	29.25	27	19	130.7	119.5	4590	5400	1.2	31310
110	42.25	40	33	209.9	211.5	4590	5400	1.85	32310	
55	90	23	23	17.5	99.2	115.2	5355	6300	0.55	32011
	90	27	27	21	110.8	136.7	5355	6300	0.67	33011
	95	30	30	23	135.5	155.5	5126	6030	0.86	33111
	100	22.75	21	18	110.7	105.6	5126	6030	0.7	30211
	100	26.75	25	21	129.7	128.7	3800	5000	0.83	32211
	100	35	35	27	169.6	189.6	4820	5670	1.2	33211
	120	31.5	29	25	175.6	162.4	4284	5040	1.55	30311
	120	31.5	29	21	122.6	138.6	4284	5040	1.55	31311
	120	45.5	43	35	244.6	254	4284	5040	2.5	32311
	60	95	27	27	21	112.6	142.5	3800	5000	0.71
100		30	30	23	143.7	169.6	3600	4800	0.92	33112
110		23.75	22	19	119.8	113.7	4590	5400	0.88	30212
110		29.75	28	24	154.7	159.6	4590	5400	1.15	32212
110		38	38	29	206.9	235.4	4590	5400	1.6	33212
130		33.5	31	26	207.5	195.6	4055	4770	1.95	30312
130		33.5	31	22	176.5	165.7	4055	4770	1.9	31312
130		48.5	46	37	281.2	289.2	4055	4770	2.85	32312
65	100	23	23	17.5	102.6	126.4	4590	5400	0.63	32013
	100	27	27	21	118.6	152.3	4820	5670	0.78	33013
	110	34	34	26.5	174.1	207	4284	5040	1.3	33113
	120	24.75	23	20	140.7	133.6	4284	5040	1.15	30213
	120	32.75	31	27	185.1	192.4	4284	5040	1.5	32213
	120	41	41	32	238	269.1	4055	4770	2.05	33213
	140	36	33	28	239.5	227.6	3672	4320	2.4	30313
	140	36	33	23	202.2	192	3672	4320	2.35	31313
	140	51	48	39	322	338	3456	4320	3.45	32313

CUSCINETTI AD UNA CORONA DI RULLI CONICI (serie metrica)
TAPERED ROLLER BEARINGS, SINGLE ROW (metric series)



Dimensioni (mm) Dimension (mm)					Coefficiente di carico (KN) Load rating (KN)		Velocità limite (giri/min) Speed limit (Rpm)		Peso (Kg) Weight (Kg)	Sigla Designation
d (mm)	D (mm)	T (mm)	B (mm)	A (mm)	Dinamico Dynamic C	Statico Static C ₀	Lubrificazione Lubrication			
							Grasso Grease	Olio Oil		
70	110	25	25	19	124	151.9	4284	5040	0.84	32014
	110	31	31	25.5	157.9	195	4284	5040	1.1	33014
	120	37	37	29	210	248.9	4055	4770	1.7	33114
	125	26.25	24	21	154	155	4055	4770	1.25	30214
	125	33.25	31	27	194	206.9	4055	4770	1.6	32214
	125	41	41	32	245.9	283.8	3825	4500	2.1	33214
	150	38	35	30	270	258.8	3443	4050	2.9	30314
	150	38	35	25	227.8	218.9	3443	4050	2.95	31314
	150	54	51	42	361.5	378.7	3443	4050	4.3	32314
75	105	20	20	16	86.5	115	4536	5670	0.52	32915
	115	25	25	19	128.9	162	4055	4770	0.9	32015
	115	31	31	25.5	165.9	226.8	4055	4770	1.15	33015
	125	37	37	29	214.8	263.9	3825	4500	1.8	33115
	130	27.25	25	22	170	174.9	3825	4500	1.4	30215
	130	33.25	31	27	195.9	210.8	3825	4500	1.7	32215
	130	41	41	31	253.9	298.8	3672	4320	2.25	33215
	160	40	37	31	300	288.9	3290	3870	3.45	30315
	160	40	37	26	253.7	244	3290	3870	3.5	31315
80	125	29	29	22	166.9	215	3825	4500	1.3	32016
	125	36	36	29.5	206	283.9	3825	4500	1.65	33016
	130	37	37	29	220	279	3672	4320	1.9	33116
	140	28.25	26	22	182.8	181.9	3672	4320	1.6	30216
	140	35.25	33	28	226.7	244.1	3443	4050	2.05	32216
	140	46	46	35	306.8	373.7	3443	4050	2.9	33216
	170	42.5	39	33	331.6	319.1	3290	3870	4.1	30316
	170	42.5	39	27	274.8	264	3060	3600	4.05	31316
	170	61.5	58	48	402.6	498.8	3290	3870	6.2	32316
85	130	29	29	22	170	222.8	2400	3400	1.35	32017
	130	36	36	29.5	221.9	308.9	3672	4320	1.75	33017
	140	41	41	32	266.7	338.6	3443	4050	2.45	33117
	150	30.5	28	24	214.9	218.8	3290	3870	2.05	30217
	150	38.5	36	30	261.9	283.9	3290	3870	2.6	32217
	150	49	49	37	351.5	428.6	3290	3870	3.7	33217
	180	44.5	41	34	370.8	363.9	3060	3600	4.85	30317
	180	44.5	41	28	295.9	293.9	2907	3420	4.6	31317
	180	63.5	60	49	433.7	528.6	3060	3600	6.85	32317
90	140	32	32	24	206.9	268.8	3290	3870	1.75	32018
	140	39	39	32.5	264.7	353.5	3443	4050	2.2	33018
	150	45	45	35	308.7	388.4	3290	3870	3.1	33118
	160	32.5	30	26	238.6	243.7	3060	3600	2.55	30218
	160	42.5	40	34	307.8	339.1	3060	3600	3.35	32218
	160	55	55	42	330.6	499.7	3060	3600	4.55	33218
	190	46.5	43	36	351.7	398.6	3060	3600	5.65	30318
	190	46.5	43	30	282	313.7	2601	3060	5.9	31318
	190	67.5	64	53	485.4	608.2	3060	3600	8.4	32318

CUSCINETTI AD UNA CORONA DI RULLI CONICI (serie metrica)
TAPERED ROLLER BEARINGS, SINGLE ROW (metric series)

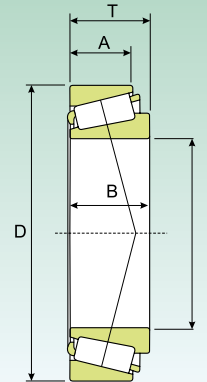

Dimensioni (mm) Dimension (mm)					Coefficiente di carico (KN) Load rating (KN)		Velocità limite (giri/min) Speed limit (Rpm)		Peso (Kg) Weight (Kg)	Sigla Designation
d (mm)	D (mm)	T (mm)	B (mm)	A (mm)	Dinamico Dynamic C	Statico Static C ₀	Lubrificazione Lubrication			
							Grasso Grease	Olio Oil		
95	145	32	32	24	204.9	268.8	3290	3870	1.8	32019
	145	39	39	32.5	271	373.7	3290	3870	2.3	33019
	170	34.5	32	27	264.8	273.7	2907	3420	3	30219
	170	45.5	43	37	346.7	389	2907	3420	4.05	32219
	200	49.5	45	38	351.8	388.8	2601	3060	6.7	30319
	200	49.5	45	32	312.9	354	2601	3060	6.95	31319
	200	71.5	67	55	533.7	668.6	2601	3060	11	32319
100	140	25	25	20	145.9	202.9	3672	4320	1.15	32920
	150	32	32	24	208	278.9	3060	3600	1.9	32020
	150	39	39	32.5	276.9	388.8	3060	3600	2.4	33020
	180	37	34	29	302.8	318.9	2754	3240	3.65	30220
	180	49	46	39	388.7	438.5	1800	2500	4.9	32220
	180	63	63	48	530.5	653	2754	3240	6.95	33220
	215	51.5	47	39	429.5	488.2	2448	2880	8.05	30320
	215	56.5	51	35	397.2	464	2295	2700	8.6	31320
215	77.5	73	60	615.6	778.7	2295	2700	12.5	32320	
105	160	35	35	26	246.5	334	2907	3420	2.4	32021
	160	43	43	34	301.8	428.9	2907	3420	3.05	33021
	190	39	36	30	331.9	353.9	2601	3060	4.25	30221
	225	53.5	49	41	461	530	2200	2800	9.1	30321
	190	53	50	43	441.9	508.7	2601	3060	6	32221
	225	81.5	77	63	643.7	813.3	2295	2700	14.5	32321
110	150	25	25	20	153	223	3290	3870	1.25	32922
	170	38	38	29	287	388.9	2754	3240	3.05	32022
	170	47	47	37	341.7	500	1800	2600	3.85	33022
	180	56	56	43	453.6	628.6	2601	3060	5.55	33122
	200	41	38	32	325.8	403.9	2448	2880	5.1	30222
	200	56	53	46	490	559	1700	2400	7.1	32222
	240	54.5	50	42	505.8	583.7	2142	2520	11	30322
	240	63	57	38	490	583.6	2142	2520	12	31322
	240	84.5	80	65	673	828.4	2142	2520	17	32322
120	165	29	29	23	203.2	303.7	2907	3420	1.8	32924
	180	38	38	29	297.8	413.8	2601	3060	3.25	32024
	180	48	48	38	354.8	538.6	2601	3060	4.2	33024
	215	43.5	40	34	415.8	463.8	2295	2700	6.15	30224
	215	61.5	58	50	571.8	693.7	2295	2700	9.15	32224
	260	59.5	55	46	600	708.8	1989	2340	14	30324
	260	68	62	42	576.5	693.7	1836	2160	15.5	31324
	260	90.5	86	69	853	1118	1989	2340	21.5	32324
130	180	32	32	25	243.9	363.8	2754	3240	2.4	32926
	200	45	45	34	386.6	538.4	2295	2700	4.95	32026
	230	43.75	40	34	450	488.7	2142	2520	7.6	30226
	230	67.75	64	54	588.7	828.5	2142	2520	11.5	32226
	280	63.75	58	49	677.7	798.5	1836	2160	17	30326
	280	72	66	44	645.5	778.7	1836	2160	18.5	31326

**CUSCINETTI AD UNA CORONA DI RULLI CONICI (serie metrica)
TAPERED ROLLER BEARINGS, SINGLE ROW (metric series)**

Dimensioni (mm) Dimension (mm)					Coefficiente di carico (KN) Load rating (KN)		Velocità limite (giri/min) Speed limit (Rpm)		Peso (Kg) Weight (Kg)	Sigla Designation
d (mm)	D (mm)	T (mm)	B (mm)	A (mm)	Dinamico Dynamic C	Statico Static C ₀	Lubrificazione Lubrication			
							Grasso Grease	Olio Oil		
140	190	32	32	25	250.8	388.6	2601	3060	2.55	32928
	210	45	45	34	402.7	584	1660	2100	5.25	32028
	250	45.75	42	36	449.9	568.7	1989	2340	8.65	30228
	250	71.75	68	58	689.7	998.3	1989	2340	14.5	32228
	300	77	70	47	691.9	898.6	1683	1980	24.5	31328
150	225	48	48	36	454.7	653.6	1989	2340	6.35	32030
	225	59	59	46	485.8	863.7	1989	2340	8.15	33030
	270	49	45	38	453.7	558.5	1836	2160	11	30230
	270	77	73	60	780.6	1138.5	1836	2160	17.5	32230
	320	82	75	50	830.7	1018.5	1530	1800	29.5	31330
160	240	51	51	38	530.8	778	1300	1800	7.75	32032
	290	52	48	40	564.6	763.5	1683	1980	13	30232
	290	84	80	67	932.1	1398	1683	1980	25.5	32232
	340	75	68	58	894	1156	1530	1800	29	30332
170	230	38	38	30	350	583.8	2142	2520	4.5	32934
	260	57	57	43	623.8	913.7	1683	1980	10.5	32034
	310	57	52	43	655.9	863.8	1530	1800	19	30234
	360	80	72	62	1000	1250	1250	1650	34.5	30334
	310	91	86	71	1073.1	1627.6	1530	1800	28.5	32234
180	250	45	45	34	433.6	733.2	1989	2340	6.65	32936
	280	64	64	48	791.8	1158	1683	1980	14.5	32036
	320	57	52	43	627.7	813.7	1530	1800	20	30236
	320	91	86	71	1067	1627.2	1454	1710	29.5	32236
190	260	45	45	34	441.5	763.2	1836	2160	7	32938
	290	64	64	48	803	1196	1530	1800	15	32038
	340	60	55	46	761.5	998.2	1377	1620	24	30238
200	280	51	51	39	583	944	1683	1980	9.5	32940
	310	70	70	53	795	1366	980	1250	19.5	32040
	360	64	58	48	842	1116	1301	1530	25	30240
	360	104	98	82	1295	1990	1301	1530	42.5	32240
220	300	51	51	39	592	992	1530	1800	10	32944
	340	76	76	57	947	1650	1301	1530	25.5	32044
	400	72	65	54	1050	1392	1224	1440	40	30244
	400	114	108	90	1710	2685	1148	1350	60	32244
240	320	51	51	39	615	1070	1454	1710	11	32948
	360	76	76	57	980	1790	1224	1440	27.5	32048
	440	127	120	100	1910	3335	1071	1260	81.5	32248
260	400	87	87	65	1220	2180	1071	1260	40	32052
	480	137	130	106	2300	3620	918	1080	105	32252
	540	113	102	85	2077	2989	918	1080	110	30352
280	380	63.5	63.5	48	749	1626	1224	1440	20	32956
	420	87	87	65	1265	2345	995	1170	40.5	32056

CUSCINETTI AD UNA CORONA DI RULLI CONICI (serie metrica)
TAPERED ROLLER BEARINGS, SINGLE ROW (metric series)



Dimensioni (mm) Dimension (mm)					Coefficiente di carico (kN) Load rating (kN)		Velocità limite (giri/min) Speed limit (Rpm)		Peso (Kg) Weight (Kg)	Sigla Designation
d (mm)	D (mm)	T (mm)	B (mm)	A (mm)	Dinamico Dynamic C	Statico Static C ₀	Lubrificazione Lubrication			
							Grasso Grease	Olio Oil		
300	420	76	76	57	1118	2220	1071	1260	32	32960
	460	100	100	74	1630	2950	918	1080	58	32060
	540	149	140	115	2695	4655	842	990	140	32260
320	440	76	76	57	1140	2340	995	1170	33.5	32964
	480	100	100	74	1650	3080	842	990	64	32064
340	460	76	76	57	1150	2380	995	1170	35	32968
360	480	76	76	57	1165	2520	918	1080	37	32972
	530	80	66	59	1030	1900	500	630	53.2	30672
	540	86	82	63.5	1270	2200	480	600	73.1	31072
400	500	60	57	47	460	950	400	500	25.1	30680
	750	130	115	77	2660	4180	320	430	222	30680-1
420	620	95	90	67	1560	2930	380	480	88.3	31084
	620	95	90	67	1560	2940	380	480	88.3	31084P5
460	860	210	190	160	5590	10100	350	470	512	30692
480	950	250	225	174	6980	12500	310	420	761	30696
500	720	110	100	82	2090	4100	360	450	128	T2GB500
530	670	100	95	82	1590	4500	340	450	81.6	318/530
	710	88	82	62	1560	3150	340	450	81.5	319/530
560	1080	265	235	208	8910	15700	180	270	1063	306/560
630	850	132	132	95	3080	7150	360	450	200	329/630
	920	135	128	94	3520	7450	320	430	289	T3GB630
	920	134	128	94	3410	7100	320	430	286	306/630
680	1000	190	188	140	5600	12600	250	350	486	306/680
710	950	114	106	80	2860	6900	230	320	210	319/710
760	890	78	75	59	1360	3520	130	170	78.3	306/760
850	1030	90	88	64	2200	5900	200	300	140	318/850
900	1180	122	122	87	3920	9100	180	260	325	T3GB900
	1280	190	170	135	6430	14600	95	130	71.8	306/900
1000	1420	210	195	150	8100	18000	160	230	966	306/1000
1270	1465	73	69	51	2100	6920	120	170	71.8	306/1270
	1465	100	100	75	3370	10690	120	170	266	306/1270-1

CUSCINETTI AD UNA CORONA DI RULLI CONICI (serie in pollici)
TAPERED ROLLER BEARINGS, SINGLE ROW (inches series)



Dimensioni (mm) Dimension (mm)					Coefficiente di carico (KN) Load rating (KN)		Velocità limite (giri/min) Speed limit (Rpm)		Peso (Kg) Weight (Kg)	Sigla Designation
d (mm/in)	D (mm/in)	T (mm/in)	B (mm/in)	A (mm/in)	Dinamico Dynamic C	Statico Static C ₀	Lubrificazione Lubrication			
							Grasso Grease	Olio Oil		
17.462 0.6875	39.878 1.5700	13.843 0.545	14.605 0.575	10.668 0.42	20 -	20 -	14400 -	18000 -	0.08 -	LM 11749/710 -
19.050 0.75	45.237 1.7810 49.225 1.9380	15.494 0.61 18.034 0.71	16.637 0.655 19.05 0.75	12.065 0.475 14.288 0.5625	33,4 - 38 -	27,2 - 39 -	12960 - 12240 -	16200 - 15300 -	0.12 - 0.17 -	LM 11949/910 - 09067/9195 -
21.430 0.8437	45.237 1.7810 50.005 1.9687	15.494 0.61 17.526 0.69	16.637 0.655 18.288 0.72	12.065 0.475 13.97 0.55	26 - 45,1 -	30 - 37,5 -	12240 - 11520 -	15300 - 14400 -	0.12 - 0.17 -	LM 12748/710 - M 12649/610 -
21.986 0.8656	45.237 1.7810 45.974 1.8100	15.494 0.61 15.494 0.61	16.637 0.655 16.637 0.655	12.065 0.475 12.065 0.475	26 - 26 -	30 - 30 -	12240 - 12240 -	15300 - 15300 -	0.12 - 0.12 -	LM 12749/710 - LM 12749/711 -
22.225 0.875	52.388 2.0625	19.368 0.7625	20.168 0.794	14.288 0.5625	40 -	43 -	10800 -	13500 -	0.20 -	1380/1328 -
25.400 1.000	50.292 1.9800 50.800 2.000 57.150 2.2500 61.999 2.4409	14.224 0.56 15.011 0.591 17.462 0.6875 19.050 0.75	14.732 0.58 14.26 0.5614 17.462 0.688 20.638 0.8125	10.668 0.42 12.7 0.50 13.495 0.531 14.288 0.5625	25 - 27 - 48,9 - 47 -	29 - 29 - 44,6 - 55 -	10800 - 10800 - 9360 - 8640 -	13500 - 13500 - 11700 - 10800 -	0.13 - 0.13 - 0.23 - 0.31 -	L 44643/610 - 07100 S/7210 X - 15578/15520 - 15101/15245 -
26.157 1.0298 26.157 1.0298	61.913 2.4375 61.999 2.4409	19.050 0.75 19.050 0.75	20.638 0.8125 20.638 0.8125	14.288 0.5625 14.288 0.5625	47 - 47 -	55 - 55 -	8640 - 8640 -	10800 - 10800 -	0.29 - 0.29 -	15103 S/15243 - 15103 S /15245 -
26.988 1.0625	50.292 1.9800	14.224 0.56	14.732 0.58	10.668 0.42	25 -	29 -	10800 -	13500 -	0.11 -	L 44649/610 -
28.575 1.1250	57.150 2.2500 57.150 2.2500 73.025 2.8750	19.845 0.7813 19.845 0.7813 22.225 0.875	19.355 0.762 19.355 0.762 22.225 0.875	15.875 0.625 15.875 0.625 17.463 0.6875	57,7 - 57,7 - 66 -	54,5 - 54,5 - 75 -	9360 - 9360 - 7200 -	11700 - 11700 - 9000 -	0.22 - 0.22 - 1.05 -	1985/1922 - 1988/1922 - 02872/2820 -
28.999 1.1417	50.292 1.9800	14.224 0.56	14.732 0.580	10.668 0.420	25 -	31 -	10080 -	12600 -	0.11 -	L 45449/410 -
31.750 1.2500	59.131 2.3280 61.912 2.4375	15.875 0.625 18.161 0.715	16.764 0.660 19.050 0.750	11.811 0.465 14.288 0.5625	34 - 47 -	40 - 55 -	8640 - 8640 -	10800 - 10800 -	0.18 - 0.24 -	LM 67048/10 - 15123/15243 -

CUSCINETTI AD UNA CORONA DI RULLI CONICI (serie in pollici)
TAPERED ROLLER BEARINGS, SINGLE ROW (inches series)



Dimensioni (mm) Dimension (mm)					Coefficiente di carico (KN) Load rating (KN)		Velocità limite (giri/min) Speed limit (Rpm)		Peso (Kg) Weight (Kg)	Sigla Designation
d (mm/in)	D (mm/in)	T (mm/in)	B (mm/in)	A (mm/in)	Dinamico Dynamic C	Statico Static C ₀	Lubrificazione Lubrication			
							Grasso Grease	Olio Oil		
31.750	61.999	18.161	19.050	14.288	59.2	56.4	8640	10800	0.24	15123/15245
1.2500	2.4409	10.715	0.750	0.5625	-	-	-	-	-	-
	73.025	29.370	27.783	23.020	85.7	94.1	7200	9000	0.62	HM 88542/510
	2.8750	1.1563	1.0938	0.9063	-	-	-	-	-	-
33.338	69.012	19.845	19.583	15.875	65.4	66.2	7920	9900	0.35	14131/14276
1.3125	2.7170	0.7813	0.771	0.625	-	-	-	-	-	-
34.925	65.088	18.034	18.288	13.970	57.2	56.3	7920	9900	0.25	LM 48548/510
1.3750	2.5625	0.71	0.720	0.550	-	-	-	-	-	-
	69.012	19.845	19.583	15.875	59.4	67.3	7920	9900	0.34	14137 A/14276
	2.7170	0.7813	0.771	0.625	-	-	-	-	-	-
	76.200	29.370	28.575	23.813	84	103	7200	9000	0.63	31594/31520
	3.000	1.1563	1.125	0.9375	-	-	-	-	-	-
34.989	59.131	15.875	16.764	11.938	40	43.3	8640	10800	0.17	L 68149/110
1.3775	2.3280	0.625	0.660	0.470	-	-	-	-	-	-
	59.974	15.875	16.764	11.938	40.1	43.6	8640	10800	0.17	L 68149/111
	2.3612	0.625	0.660	0.470	-	-	-	-	-	-
36.487	73.025	23.812	24.608	19.050	70	86	7200	9000	0.45	25880/25820
1.4365	2.8750	0.9375	0.9688	0.750	-	-	-	-	-	-
38.100	65.088	18.034	18.288	13.970	49	55	7920	9900	0.25	LM 29748/710
1.5	2.5625	0.71	0.720	0.550	-	-	-	-	-	-
	65.088	18.034	18.288	13.970	49	55	7920	9900	0.25	LM 29749/710
	2.5625	0.71	0.720	0.550	-	-	-	-	-	-
	65.088	19.812	18.288	15.748	52.1	56.3	7920	9900	0.25	LM 29749/711
	2.5625	0.78	0.720	0.620	-	-	-	-	-	-
	72.238	20.638	20.638	15.875	55.5	60.2	7200	9000	0.39	16150/16284
	2.8440	0.8125	0.8125	0.625	-	-	-	-	-	-
	72.238	23.812	20.638	19.050	55.5	60.2	7200	9000	0.39	16150/16283
	2.8440	0.9375	0.8125	0.750	-	-	-	-	-	-
	82.550	29.370	28.575	23.020	104.8	116.6	6120	7650	0.78	HM 801346/310
	3.2500	1.1563	1.125	0.9063	-	-	-	-	-	-
	88.500	26.988	29.083	22.225	1215	112.5	6480	8100	0.83	418/414
	3.4843	1.0625	1.145	0.875	-	-	-	-	-	-
39.688	73.025	25.654	22.098	21.336	64	84	7200	9000	0.45	M 201047/11
1.5625	2.8750	1.0100	0.870	0.840	-	-	-	-	-	-
40.988	67.975	17.501	18.001	13.500	43	57	7200	9000	0.24	LM 300849/811
1.6137	2.6762	0.689	0.7087	0.5315	-	-	-	-	-	-
41.275	73.025	16.670	17.463	12.700	45	54	7200	9000	0.27	18590/18520
1.625	2.8750	0.6563	0.6875	0.500	-	-	-	-	-	-
	73.431	19.558	19.812	14.732	66.9	67.3	7200	9000	0.33	LM 501349/310
	2.8910	0.77	0.780	0.580	-	-	-	-	-	-
	73.431	21.430	19.812	16.604	66.9	67.3	7200	9000	0.35	LM 501349/314
	2.8910	0.8437	0.780	0.6537	-	-	-	-	-	-
	76.200	18.009	17.384	14.288	83.1	85	6840	8550	0.34	11162/11300
41.275	3.000	0.709	0.6844	0.5625	-	-	-	-	-	-

CUSCINETTI AD UNA CORONA DI RULLI CONICI (serie in pollici)
TAPERED ROLLER BEARINGS, SINGLE ROW (inches series)



Dimensioni (mm) Dimension (mm)					Coefficiente di carico (KN) Load rating (KN)		Velocità limite (giri/min) Speed limit (Rpm)		Peso (Kg) Weight (Kg)	Sigla Designation
d (mm/in)	D (mm/in)	T (mm/in)	B (mm/in)	A (mm/in)	Dinamico Dynamic C	Statico Static C ₀	Lubrificazione Lubrication			
							Grasso Grease	Olio Oil		
41.275 1.625	76.200 3.000	18.009 0.709	17.384 0.6844	14.288 0.5625	83.1 -	85 -	6840 -	8550 -	0.34 -	11163/11300 -
	76.200 3.000	22.225 0.875	23.020 0.9063	17.463 0.6875	83.1 -	85 -	6840 -	8550 -	0.43 -	24780/24720 -
	87.312 3.4375	30.162 1.1875	30.886 1.2160	23.812 0.9375	124.3 -	130.4 -	6120 -	7650 -	0.85 -	3585/3525 -
	88.900 3.5000	30.162 1.1875	29.370 1.1563	23.020 0.9063	115 -	125.6 -	5760 -	7200 -	0.90 -	HM 803146/110 -
	101.600 4.000	34.925 1.3750	36.068 1.420	26.988 1.0625	147 -	186 -	5400 -	6750 -	1.45 -	526/522 -
44.450 1.750	82.931 3.2650	23.812 0.9375	25.400 1	19.050 0.75	98.2 -	104.9 -	6480 -	8100 -	0.57 -	25580/25520 -
	82.931 3.2650	26.988 1.0625	25.400 1	22.225 0.875	98.2 -	104.9 -	6480 -	8100 -	0.57 -	25580/25523 -
	83.058 3.2700	23.876 0.94	25.400 1	19.114 0.7525	98.2 -	104.9 -	6480 -	8100 -	0.57 -	25580/25522 -
	88.900 3.5000	30.162 1.1875	29.370 1.1563	23.020 0.9063	114.8 -	125.6 -	5760 -	7200 -	0.80 -	HM 803149/110 -
	95.250 3.7500	30.955 1.2187	28.300 1.1142	20.638 0.8125	106.9 -	95.1 -	5040 -	6300 -	0.93 -	53178/53377 -
45.237 1.7810	87.313 3.4375	30.162 1.1875	30.886 1.2160	23.812 0.9375	99 -	129 -	6120 -	7650 -	0.85 -	3586/3525 -
45.242 1.7812	73.431 2.8910	19.558 0.77	19.812 0.78	15.748 0.62	65.2 -	74.1 -	6840 -	8550 -	0.30 -	LM 102949/910 -
	77.788 3.0625	19.842 0.7812	19.842 0.7812	15.080 0.5937	66.1 -	68.9 -	6480 -	8100 -	0.37 -	LM 603049/011 -
45.618 1.7960	82.931 3.2650	23.812 0.9375	25.400 1.000	19.050 0.75	98.6 -	104.8 -	6480 -	8100 -	0.55 -	25590/25520 -
	82.931 3.2650	26.988 1.0625	25.400 1.000	22.225 0.875	98.6 -	104.8 -	6480 -	8100 -	0.55 -	25590/25523 -
	83.058 3.2700	23.876 0.94	25.400 1.000	19.114 0.7525	98.6 -	104.8 -	6480 -	8100 -	0.55 -	25590/25522 -
46.038 1.8105	79.375 3.1250	17.462 0.6875	17.462 0.6875	13.495 0.5313	48 -	60 -	6480 -	8100 -	0.33 -	18690/18620 -
47.625 1.8750	101.600 4.000	34.925 1.3750	36.068 1.4200	26.988 1.0625	147 -	186 -	5400 -	6750 -	1.25 -	528 R/522 -
50.800 2.0000	82.550 3.250	21.590 0.85	22.225 0.875	16.510 0.65	70 -	98 -	6120 -	7650 -	0.43 -	LM 104949/911 -
	85.000 3.3465	17.462 0.6875	17.462 0.6875	13.495 0.5313	61.4 -	65.2 -	6120 -	7650 -	0.37 -	18790/18720 -
	88.900 3.500	20.637 0.8125	22.225 0.875	16.513 0.6501	92.9 -	90.8 -	5760 -	7200 -	0.50 -	368 A/362 A -
	93.264 3.6718	30.162 1.1875	30.302 11.930	23.812 0.9375	107 -	143 -	5400 -	6750 -	0.85 -	3780/3720 -

CUSCINETTI AD UNA CORONA DI RULLI CONICI (serie in pollici)
TAPERED ROLLER BEARINGS, SINGLE ROW (inches series)



Dimensioni (mm) Dimension (mm)					Coefficiente di carico (KN) Load rating (KN)		Velocità limite (giri/min) Speed limit (Rpm)		Peso (Kg) Weight (Kg)	Sigla Designation
d (mm/in)	D (mm/in)	T (mm/in)	B (mm/in)	A (mm/in)	Dinamico Dynamic C	Statico Static C ₀	Lubrificazione Lubrication			
							Grasso Grease	Olio Oil		
50.800 2.0000	97.630 3.8437	24.608 0.9688	24.608 0.9688	19.446 0.7656	87 -	126 -	5040 -	6300 -	0.83 -	28678/28622 -
	104.775 4.1250	39.688 1.5625	40.157 1.5810	33.338 1.3125	153 -	219 -	5040 -	6300 -	1.65 -	4580 /4535 -
	107.950 4.2500	36.512 1.4375	36.957 1.4550	28.575 1.1250	181.8 -	188.2 -	5040 -	6300 -	1.55 -	537/532 X -
53.975 2.1250	88.900 3.5000	19.050 0.75	19.050 0.75	13.492 0.5313	70.2 -	77.1 -	5760 -	7200 -	0.43 -	LM 806649/610 -
	95.250 3.7500	27.783 1.0938	28.575 1.1250	22.225 0.875	102 -	134 -	5400 -	6750 -	0.80 -	33895/33821 -
	95.250 3.7500	27.783 1.0938	28.575 1.1250	22.225 0.875	102 -	134 -	5400 -	6750 -	0.80 -	33895/33822 -
57.150 2.2500	96.838 3.8125	21.000 0.8268	21.946 0.864	15.875 0.625	98.2 -	100.9 -	5400 -	6750 -	0.59 -	387A/382 A -
	96.838 3.8125	25.400 1.000	21.946 0.864	20.274 0.7982	98.2 -	100.9 -	5400 -	6750 -	0.70 -	387 A/382 S -
	98.425 3.8750	21.000 0.8268	21.946 0.864	17.826 0.7018	98.2 -	100.9 -	5400 -	6750 -	0.58 -	387 A/382 -
	104.775 4.1250	30.162 1.1875	29.317 1.1542	24.605 0.9687	150 -	159 -	5040 -	6300 -	1.05 -	462/453 X -
	112.712 4.4375	30.162 1.1875	30.162 1.1875	23.812 0.9375	173.2 -	202.1 -	4536 -	5670 -	1.45 -	39580/39520 -
	119.985 4.7238	32.753 1.2895	30.162 1.1875	26.949 1.0610	173.2 -	202.1 -	4536 -	5670 -	1.75 -	39580/39528 -
63.500 2.5000	112.712 4.4375	30.162 1.8175	30.048 1.1830	23.812 0.9375	150.8 -	181.7 -	4536 -	5670 -	1.25 -	3982/3920 -
65.088 2.5625	135.755 5.3447	53.975 2.1250	56.007 2.2050	44.450 1.7500	351.1 -	397.6 -	4032 -	5040 -	3.70 -	6379/K6320 -
66.675 2.6250	112.712 4.4375	30.162 1.8175	30.162 1.1875	23.812 0.9375	173.6 -	201.9 -	4536 -	5670 -	1.20 -	39590/39520 -
	119.985 4.7238	32.753 1.2895	30.162 1.1875	26.949 1.0610	173.6 -	201.9 -	4536 -	5670 -	1.50 -	39590/39528 -
69.850 2.7500	112.712 4.4375	25.400 1.000	25.400 1.000	19.050 0.75	141 -	186 -	4320 -	5400 -	0.97 -	29675/29620 -
	127.000 5.000	36.512 1.4375	36.170 1.4240	28.575 1.1250	214.2 -	252.1 -	4032 -	5040 -	1.90 -	566/563 -
71.438 2.8125	117.475 4.6250	30.162 1.1875	30.162 1.1875	23.812 0.9375	150.1 -	188.4 -	4320 -	5400 -	1.25 -	33281/33462 -
73.025 2.8750	112.712 4.4375	25.400 1.000	25.400 1.000	19.050 0.75	130.1 -	169.2 -	4320 -	5400 -	0.89 -	29685/29620 -
	117.475 4.6250	30.162 1.1875	30.162 1.1875	23.812 0.9375	169.6 -	217.4 -	4320 -	5400 -	1.20 -	33287/33462 -

CUSCINETTI AD UNA CORONA DI RULLI CONICI (serie in pollici)
TAPERED ROLLER BEARINGS, SINGLE ROW (inches series)



Dimensioni (mm) Dimension (mm)					Coefficiente di carico (KN) Load rating (KN)		Velocità limite (giri/min) Speed limit (Rpm)		Peso (Kg) Weight (Kg)	Sigla Designation
d (mm/in)	D (mm/in)	T (mm/in)	B (mm/in)	A (mm/in)	Dinamico Dynamic C	Statico Static C ₀	Lubrificazione Lubrication			
							Grasso Grease	Olio Oil		
76.200 3.000	127.000 5.000	30.162 1.1875	31.000 1.2205	22.225 0.875	170.1 -	202.2 -	3816 -	4770 -	1.4 -	42687/42620 -
	139.992 5.5115	36.512 1.4375	36.098 1.4212	28.575 1.1250	225 -	278.2 -	3600 -	4500 -	2.45 -	575/572 -
82.550 3.2500	139.992 5.5115	36.512 1.4375	36.098 1.4212	28.575 1.1250	224.2 -	278.3 -	3600 -	4500 -	2.20 -	580/572 -
	146.050 5.7500	41.275 1.6250	41.275 1.6250	31.750 1.2500	266.9 -	318.1 -	3456 -	4320 -	2.80 -	663/653 -
88.900 3.500	152.400 6.000	39.688 1.5625	36.322 1.4300	30.162 1.1875	234.1 -	302.9 -	3240 -	4050 -	2.80 -	593/592 A -
92.075 3.625	152.400 6.000	39.688 1.5625	36.322 1.4300	30.162 1.1875	234.1 -	302.9 -	3240 -	4050 -	2.70 -	598/592 A -
95.250 3.750	146.050 5.7500	33.338 1.3125	34.925 1.3750	26.195 1.0313	201.3 -	276.4 -	3240 -	4050 -	1.90 -	47896/47820 -
	152.400 6.000	39.688 1.5625	36.322 1.4300	30.162 1.1875	234.1 -	302.9 -	3240 -	4050 -	2.55 -	594/592 A -
101.600 4.000	168.275 6.6250	41.275 1.6250	41.275 1.6250	30.162 1.1875	284.1 -	362.2 -	2880 -	3600 -	3.45 -	687/672 -
114.300 4.500	177.800 7.000	41.275 1.6250	41.275 1.6250	30.162 1.1875	303.1 -	411.1 -	2736 -	3420 -	3.60 -	64450/64700 -
	180.975 7.1250	34.925 1.3750	31.750 1.2500	25.400 1.000	222.6 -	276.2 -	2736 -	3420 -	2.95 -	68450/68712 -
127.000 5.000	182.562 7.1875	39.688 1.5625	38.100 1.5000	33.338 1.3125	276.4 -	436.6 -	2592 -	3240 -	3.30 -	48290/48220 -
	196.850 7.7500	46.038 1.8125	46.038 1.8125	38.100 1.500	312 -	573 -	2448 -	3060 -	5.20 -	67388/67322 -
133.350 5.250	196.850 7.7500	46.038 1.8125	46.038 1.8125	38.100 1.5000	389.9 -	580.4 -	2448 -	3060 -	4.80 -	67391/67322 -
139.700 5.500	236.538 9.3125	57.150 2.2500	56.642 2.2300	44.450 1.7500	624.9 -	844.9 -	2016 -	2520 -	10.00 -	HM 231132/110 -
158.750 6.250	205.583 8.0938	23.812 0.9375	23.812 0.9375	18.258 0.7188	165.1 -	276.4 -	2160 -	2700 -	1.95 -	L 432348/310 -
	205.583 8.0938	23.812 0.9375	23.812 0.9375	18.258 0.7188	165.1 -	276.4 -	2160 -	2700 -	1.95 -	L 432349/310 -
177.800 7.000	227.012 8.9375	30.162 1.1875	30.162 1.1875	23.020 0.9063	183 -	416 -	2016 -	2520 -	3.00 -	36990/36920 -
191.237 7.5290	279.400 11.000	53.975 2.1250	58.738 2.3125	41.275 1.6250	501 -	851 -	1584 -	1980 -	10.00 -	M 239448 A/410 -
196.850 7.7500	241.300 9.5000	2.3812 0.9375	23.813 0.9062	17.462 0.6875	185.9 -	311.6 -	1872 -	2340 -	2.00 -	LL 639249/210 -

CUSCINETTI AD UNA CORONA DI RULLI CONICI (serie in pollici)
TAPERED ROLLER BEARINGS, SINGLE ROW (inches series)



Dimensioni (mm) Dimension (mm)					Coefficiente di carico (KN) Load rating (KN)		Velocità limite (giri/min) Speed limit (Rpm)		Peso (Kg) Weight (Kg)	Sigla Designation
d (mm/in)	D (mm/in)	T (mm/in)	B (mm/in)	A (mm/in)	Dinamico Dynamic C	Statico Static C ₀	Lubrificazione Lubrication			
							Grasso Grease	Olio Oil		
216.408 8.5200	285.750 11.2500	46.038 1.8125	49.212 1.9375	34.924 1.3750	372 -	807 -	1584 -	1980 -	7.85 -	LM 742747/710 -
230.188 9.0625	317.500 12.5000	47.628 1.8751	52.388 2.0625	36.512 1.4375	550 -	974 -	1440 -	1800 -	10.50 -	LM 245846/810 -
231.775 9.1250	317.500 12.5000	47.628 1.8751	52.388 2.0625	36.512 1.4375	550 -	974 -	1440 -	1800 -	10.50 -	LM 245848/810 -
255.600 10.0630	342.900 13.5000	57.150 2.2500	63.500 2.5000	44.450 1.7500	692 -	1389 -	1296 -	1620 -	14.00 -	M 349547/510 -
257.175 10.1250	358.775 14.1250	71.438 2.8125	76.200 3.000	53.975 2.1250	1020 -	1742 -	1224 -	1530 -	20.50 -	M 249747/710 -
263.525 10.3750	325.438 12.8125	28.575 1.1250	2.8575 1.1250	25.400 1.000	269 -	544 -	1296 -	1620 -	5.2 -	38880/38820 -
266.7 10.500	355.6 393.7	57.15 73.817	57.15 69.85	44.45 50.005	715 770	1400 1460	850 750	1200 1000	15.1 27.8	LM451349/LM451310 EE275105/275155
273.05 10.75	393.7 15.5	73.817 2.906	69.85 2.75	50.005 1.969	770 -	1460 -	750 -	1000 -	26.3 -	EE275108/275155 -
288.925 11.375	406.4 16	77.788 3.062	77.788 3.062	60.325 2.375	1190 -	1900 -	670 -	900 -	30.5 -	M255449/M255410 -
292.100 11.5	374.650 14.75	47.625 1.875	47.625 1.875	34.925 1.375	535 -	1150 -	780 -	1050 -	12.2 -	L555249/L555210 -
304.8 12	393.7 15.5	50.8 2	50.8 2	38.1 1.5	580 -	1210 -	670 -	900 -	14.6 -	L357049/L357010 -
12 12	406.4 16	63.5 2.5	63.5 2.5	47.625 1.875	771 -	1740 -	670 -	900 -	21.2 -	LM757049/LM757010 -
12	499.948 19.683	101.6 4	79.375 3.125	53.975 2.125	1250 -	1750 -	560 -	750 -	65 -	M959442/M959410 -
317.5 12.5	447.675 17.625	85.725 3.375	85.725 3.375	68.262 2.687	1349 -	2679 -	670 -	900 -	41.3 -	HM259048/HM259010 -
330.200 13	482.600 19	85.725 3.375	80.167 3.156	60.325 2.375	1250 -	2320 -	600 -	830 -	45 -	EE526130/526190 -
333.375 13.125	469.900 18.5	90.488 3.562	90.488 3.562	71.438 2.812	1401 -	2835 -	600 -	830 -	47.6 -	HM261049/HM261010 -
343.154 13.51	450.850 17.75	66.675 2.625	66.675 2.625	52.388 2.0625	1110 -	2180 -	650 -	850 -	27 -	LM361649A/LM361610 -
346.075 13.625	488.950 19.25	95.250 3.75	95.250 3.75	74.612 2.9375	1730 -	3760 -	600 -	830 -	55.8 -	HM262749/HM262710 -

CUSCINETTI AD UNA CORONA DI RULLI CONICI (serie in pollici)
TAPERED ROLLER BEARINGS, SINGLE ROW (inches series)



Dimensioni (mm) Dimension (mm)					Coefficiente di carico (KN) Load rating (KN)		Velocità limite (giri/min) Speed limit (Rpm)		Peso (Kg) Weight (Kg)	Sigla Designation
d (mm/in)	D (mm/in)	T (mm/in)	B (mm/in)	A (mm/in)	Dinamico Dynamic C	Statico Static C ₀	Lubrificazione Lubrication			
							Grasso Grease	Olio Oil		
355.6 14	482.6 19	60.320 2.375	55.560 2.187	38.1 1.5	565 -	1180 -	600 -	830 -	26.6 -	431884 A -
377.825 14.875	522.288 2.056	85.725 3.375	84.138 3.312	61.912 2.437	1170 -	2580 -	670 -	900 -	51.9 -	LM565946/LM565910 -
381	479.425 18.875	49.212 1.937	47.625 1.875	34.925 1.375	625 -	1490 -	560 -	750 -	20.4 -	L865547/L865512 -
15	508.000 20	63.500 2.5	58.738 2.312	38.100 1.5	700 -	1400 -	560 -	750 -	29.4 -	EE192150/192200 -
15	522.288 20.562	85.725 3.375	84.138 3.312	61.912 2.437	1170 -	2850 -	650 -	870 -	51.2 -	LM565949/LM565910 -
384.175 15.125	546.100 21.5	104.775 4.125	104.775 4.125	82.550 3.25	1850 -	4150 -	530 -	700 -	77.6 -	HM266449/HM266410 -
403.225 15.875	460.375 18.125	28.575 1.125	28.575 1.125	20.638 0.812	230 -	708 -	560 -	750 -	6.73 -	LL566848/LL566810 -
406.4	546.1 21.5	76.2 3	61.12 2.406	55.562 2.187	840 -	1830 -	630 -	850 -	41.8 -	EE234160/234215 -
16	549.275 21.625	85.725 3.375	84.138 3.312	61.913 2.437	1439 -	3000 -	600 -	800 -	54.0 -	LM567949/LM567910 -
16	574.675 22.625	76.2 3	67.866 2.672	50.8 2	920 -	2030 -	500 -	650 -	54.2 -	EE285160/285226 -
16	762 30	180.975 7.125	161.925 6.375	107.950 4.25	3650 -	6050 -	350 -	480 -	322 -	H969249/H969210 -
415.925 16.375	590.55 23.25	114.3 4.5	114.3 4.5	88.9 3.5	1810 -	4030 -	480 -	650 -	96.9 -	M268749/M268710 -
430.212 16.9375	603.250 23.75	76.2 3	73.025 2.875	50.8 2	1050 -	2190 -	480 -	650 -	58.6 -	EE241693/242375 -
447.675 17.625	635 25	120.650 4.75	120.650 4.75	95.250 3.75	2300 -	5450 -	430 -	560 -	121 -	M270749/M270710 -
457.2	573.088 22.562	74.612 2.937	74.612 2.937	57.150 2.25	1180 -	2980 -	480 -	630 -	43.8 -	L570649/L570610 -
18	603.250 23.75	85.725 3.375	84.138 3.312	60.325 2.375	1530 -	3390 -	450 -	600 -	62.0 -	LM770949/LM770910 -
18	615.950 24.25	85.725 3.375	85.725 3.375	66.675 2.625	1550 -	3750 -	420 -	580 -	73.2 -	LM272235/LM272210 -
18	660.400 26	91.280 3.593	85.725 3.375	62.705 2.468	1750 -	3600 -	420 -	580 -	91.5 -	EE737181/737260 -
482.6 19	634.873 24.995	80.962 3.187	80.962 3.187	63.5 2.5	1540 -	3600 -	420 -	580 -	66 -	EE243190/243250 -
488.95 19.25	634.873 24.995	84.138 3.312	84.138 3.312	61.912 2.437	1530 -	3600 -	420 -	580 -	64.5 -	LM772748/LM772710 -
498.475 19.625	634.873 24.995	80.962 3.187	80.962 3.187	63.5 2.5	1440 -	3600 -	420 -	580 -	58.3 -	EE243196/243250 -

CUSCINETTI AD UNA CORONA DI RULLI CONICI (serie in pollici)
TAPERED ROLLER BEARINGS, SINGLE ROW (inches series)

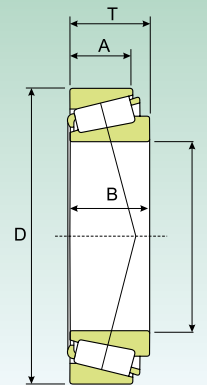

Dimensioni (mm) Dimension (mm)					Coefficiente di carico (KN) Load rating (KN)		Velocità limite (giri/min) Speed limit (Rpm)		Peso (Kg) Weight (Kg)	Sigla Designation
d (mm/in)	D (mm/in)	T (mm/in)	B (mm/in)	A (mm/in)	Dinamico Dynamic C	Statico Static C ₀	Lubrificazione Lubrication			
							Grasso Grease	Olio Oil		
520.7 20.5	736.6 29	88.9 3.5	81.758 3.219	53.975 2.125	1630 -	3350 -	380 -	500 -	101 -	EE982051/982900 -
536.575 21.125	761.873 29.995 820 32.283	146.05 5.75 152 5.984	146.05 5.75 146 5.748	114.3 4.5 112 4.409	3570 3850 -	7950 7750 -	360 340 -	480 450 -	202 273 -	M276449/M276410 BT1B 328017/HA4 -
539.750 21.25	635 25	50.8 2	50.8 2	38.1 1.5	780 -	2040 -	400 -	530 -	27.2 -	LL575349/LL575310 -
607.72 23.926	787.4 31	93.662 3.687	93.662 3.687	69.85 2.75	2120 -	5250 -	340 -	450 -	108 -	EE649239/649310 -
609.6 24	787.4 31	93.662 3.687	93.662 3.687	69.85 2.75	2120 -	5250 -	340 -	450 -	108 -	EE649240/649310 -
635 25	736.6 29	57.15 2.25	53.975 2.125	41.275 1.625	654 -	1830 -	350 -	470 -	33 -	80780/80720 -
660.4 26 26	812.8 32 939.8 37 1000 39.37	95.25 3.75 136.525 5.375 152.4 6	95.25 3.75 127.00 5 142.24 5.6	73.025 2.875 98.425 3.875 113.665 4.475	2074 - 3560 - 4597 -	5550 - 7800 - 9450 -	310 - 260 - 240 -	420 - 360 - 340 -	106 - 270 - 411 -	L281147/L281110 - EE538260/538370 - BT1B 334140/HA4 -
679.45 26.75	901.7 35.5	142.875 5.625	142.875 5.625	111.125 4.375	3550 -	8900 -	260 -	360 -	243 -	LM281849/LM281810 -
682.625 26.875	965.2 38 1080 42.519	185.738 7.312 200 7.874	185.738 7.312 195 7.677	142.875 5.625 142 5.59	5050 6650 -	12480 - 13100 -	240 - 200 -	340 - 300 -	419 - 641 -	M282249/M282210 - BT1B332705/HA4 -
685.8 27	876.3 34.5	93.662 3.687	92.075 3.638	69.85 2.75	2100 -	4950 -	280 -	380 -	134 -	EE655270/655345 -
711.2 28	914.4 36	85.725 3.375	82.550 3.25	60.325 2.375	2000 -	4850 -	220 -	320 -	132 -	EE755280/755360 -
723.9 28.5	914.4 36	84.137 3.312	80.962 3.187	60.325 2.375	2000 -	4850 -	260 -	360 -	116 -	EE755285/755360 -
749.3 29.5	990.6 39	159.5 6.279	160.388 6.314	123 4.842	4880 -	11800 -	220 -	320 -	331 -	LM283649/LM283610 -
759.925 29.9183	889 22.58	69.85 2.75	69.85 2.75	50.8 2	1210 -	3750 -	260 -	360 -	67.2 -	LL483448/LL483418 -
759.925 29.9183 762 30	889 35 889 35	88.9 3.5 88.9 3.5	88.9 3.5 88.9 3.5	72 2.834 72 2.834	2200 - 2200 -	6230 - 6230 -	260 - 260 -	360 - 360 -	93.5 - 91.9 -	L183448/L183410 - L183449/L183410 -

**CUSCINETTI AD UNA CORONA DI RULLI CONICI (serie in pollici)
TAPERED ROLLER BEARINGS, SINGLE ROW (inches series)**

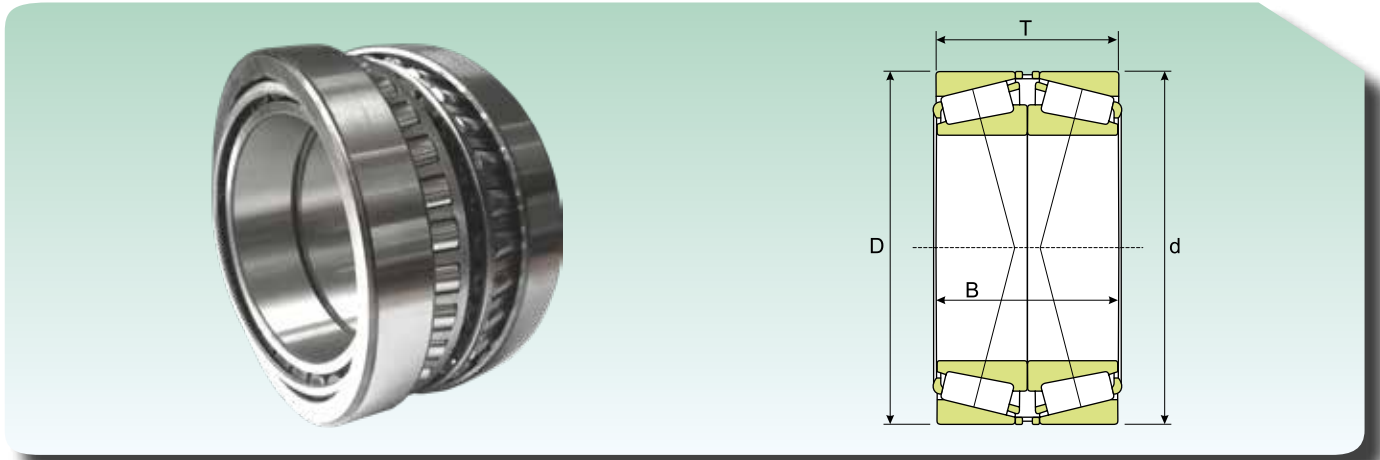

Dimensioni (mm) Dimension (mm)					Coefficiente di carico (KN) Load rating (KN)		Velocità limite (giri/min) Speed limit (Rpm)		Peso (Kg) Weight (Kg)	Sigla Designation
d (mm/in)	D (mm/in)	T (mm/in)	B (mm/in)	A (mm/in)	Dinamico Dynamic C	Statico Static C ₀	Lubrificazione Lubrication			
							Grasso Grease	Olio Oil		
774.7 30.5	965.2 38	93.662 3.687	80.962 3.187	66.675 2.625	1920 -	4850 -	220 -	320 -	130 -	EE752305/752380 -
801.688 31.5625	914.4 36	58.738 2.312	58.738 2.312	41.275 1.629	1050 -	3500 -	240 -	340 -	53.6 -	LL584449/LL584410 -
838.2 33	1041.4 41	93.662 3.687	88.9 3.5	66.675 2.625	2110 -	5160 -	200 -	300 -	161 -	EE763330/763410 -
928 36.5354	1060 41.732	92 3.622	90 3.543	76 2.992	2120 -	7450 -	190 -	280 -	117 -	JL286948H/JL286910 -
930 36.6142	1060 41.732	92 3.622	90 3.543	76 2.992	2120 -	7450 -	190 -	280 -	115 -	JL286949H/JL286910 -
977.9 38.5	1130.3 44.5	66.675 2.625	63.5 2.5	47.625 1.875	1430 -	4300 -	170 -	240 -	101 -	LL687949/LL687910 -
1016 40	1270 50	101.6 4	101.6 4	66.675 2.625	2700 -	7450 -	160 -	230 -	265 -	EE168400/168500 -

CUSCINETTI A RULLI CONICI, AD UNA CORONA, APPAIATI AD "X"
TAPERED ROLLER BEARINGS, SINGLE ROW, FACE-TO-FACE

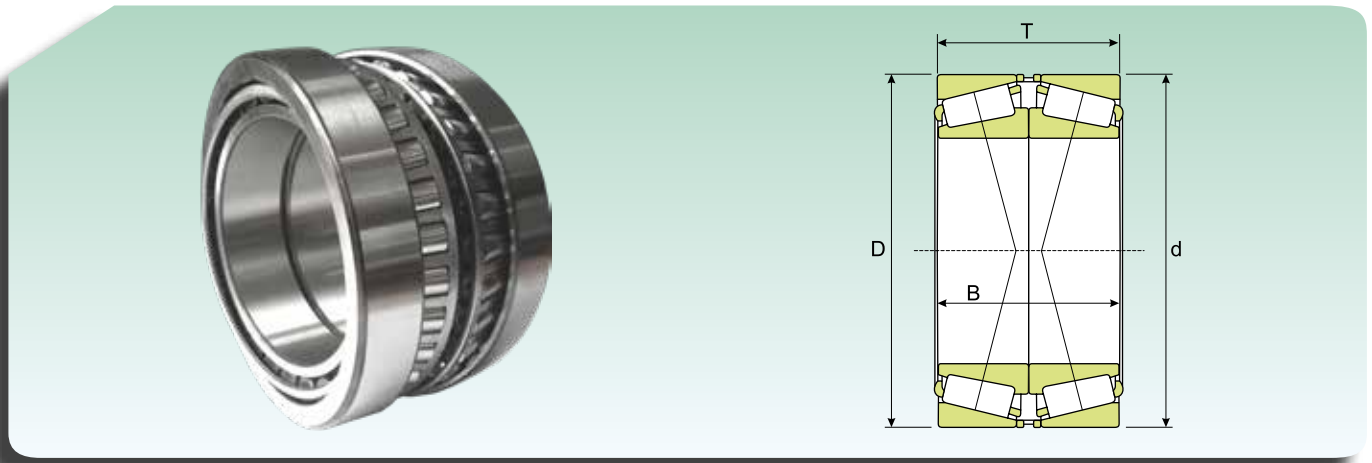

Dimensioni (mm) Dimension (mm)			Coefficiente di carico (KN) Load rating (KN)		Velocità limite (giri/min) Speed limit (Rpm)		Peso (Kg) Weight (Kg)	Sigla Designation
d (mm)	D (mm)	T (mm)	Dinamico Dynamic C	Statico Static C ₀	Lubrificazione Lubrication			
					Grasso Grease	Olio Oil		
25	62	36,5	79.2	80	9900	10450	0,55	31305 J/DF
30	72	41,5	99	99	8550	9025	0,85	31306 J/DF
35	80	45,5	128	133	7650	8075	1,10	31307 J/DF
40	90	50,5	154.5	161.7	6750	7125	1,50	31308 J/DF
45	100	54,5	193	202.6	6030	6365	2,00	31309 J/CDF
50	90	43,5	158	181.6	6750	7125	1,10	30210 J/DF
	110	58,5	222	237.7	5400	5700	2,6	31310 J/DF
55	90	54	176,4	264,6	6300	6650	1,35	33011/DF03C170
	120	63	252.5	272.8	5040	5320	3,30	31311 J/DF
60	95	46	159,74	240,1	6030	6365	1,90	32012 X/DFC250
	130	67	300	331.8	4770	5035	4,10	31312 J/DF
65	120	49,5	223,44	264,6	5040	5320	1,20	30213 J/DF
	140	72	344.4	376.6	4320	4560	5,05	31313 J/DF
70	110	62	269.1	395.8	5040	5320	2,40	33014/DF
	150	76	388.8	436.5	4050	4275	6,15	31314 J/DF
75	115	62	281.4	450.1	4770	5035	2,40	33015/DF
	125	74	362.1	521.8	4500	4750	3,80	33115/DFC150
	130	54,5	233,24	347,9	4500	4750	2,85	30215 J/DF
	130	66,5	331.2	420.9	4500	4750	3,40	32215 J/DF
	160	80	433.2	483.6	3870	4085	7,25	31315 J/DF
80	125	58	282.6	425.2	4500	4750	2,65	32016 X/DFC165
	140	70,5	384.4	484.1	4050	4275	4,25	32216 J/DF
	170	85	375.1	524.6	3600	3800	8,75	31316 J1/DF
85	130	58	284.9	445.4	4320	4560	2,80	32017 X/DF
	130	72	301,84	607,6	4320	4560	3,55	33017/DFC240
	150	61	296,94	431,2	3870	4085	4,30	30217 J/DF
	150	77	444,4	563,8	3870	4085	5,45	32217 J/DF
	150	98	485,1	833	3870	4085	7,35	33217/DF
	180	89	503.9	562.6	3420	3610	10,0	31317 J/DF
90	140	64	351.1	535.9	3870	4085	3,65	32018 X/DF
	140	78	450.1	703.3	4050	4275	4,50	33018/DFC150
	160	65	405.1	484.7	3600	3800	5,15	30218 J/DF
	160	85	522.1	672.7	3600	3800	6,90	32218 J/DF
	190	93	480.1	623.9	3060	3230	11,5	31318 J/DF
95	145	78	372,4	720,3	3870	4085	5,00	33019/DF
	170	91	590.1	771.2	3420	3610	8,45	32219 J/DF
	200	99	532.1	701.9	3060	3230	13,0	31319 J/DF

CUSCINETTI A RULLI CONICI, AD UNA CORONA, APPAIATI AD "X"
TAPERED ROLLER BEARINGS, SINGLE ROW, FACE-TO-FACE



Dimensioni (mm) Dimension (mm)			Coefficiente di carico (kN) Load rating (kN)		Velocità limite (giri/min) Speed limit (Rpm)		Peso (Kg) Weight (Kg)	Sigla Designation
d (mm)	D (mm)	T (mm)	Dinamico Dynamic C	Statico Static C ₀	Lubrificazione Lubrication			
					Grasso Grease	Olio Oil		
100	150	64	350.1	555.5	3600	3800	3,95	32020 X/DF
	180	74	515.5	634.4	3240	3420	7,60	30220 J/DF
	180	98	659.2	873.1	3240	3420	10,0	32220 J/DF
	215	103	679,14	960,4	2880	3040	16,5	30320J/DFC400
	215	113	677.7	922.2	2700	2850	18,0	31320 XJ/DF
105	160	70	421	662.1	3420	3610	5,00	32021 X/DF
110	170	76	486.8	772.8	3240	3420	6,30	32022 X/DF
	180	112	770.8	1239.6	3060	3230	11,5	33122/DF
	200	82	519.1	792	2880	3040	10,5	30222 J/DF
	200	112	826.1	1130	2880	3040	14,5	32222 J/DF
	240	126	832	1151.1	2520	2660	26,0	31322 XJ/DF
120	180	76	510.1	822.6	3060	3230	6,75	32024 X/DF
	180	96	602.9	1073	3060	3230	8,65	33024/DFC250
	215	87	700.1	909.6	2700	2850	13,0	30224 J/DF
	215	123	974.4	1400	2700	2850	18,5	32224 J/DF
	260	119	948,64	1372	2340	2470	29,5	30324 J/DFC600
	260	136	985.4	1395	2160	2280	38,5	31324 XJ/DF
130	180	64	402.9	722.2	3240	3420	4,95	32926/DF
	200	90	651.9	1070.2	2700	2850	10,0	32026 X/DF
	230	87,5	768.1	972.6	2520	2660	14,5	30226 J/DF
	230	135,5	1000	1650	2520	2660	23,0	32226 J/DF
	280	144	1100	1544.2	2160	2280	40,0	31326 XJ/DF
140	210	90	684.1	1150.3	2520	2660	11,0	32028 X/DF
	250	91,5	764.1	1129.9	2340	2470	18,0	30228 J/DFC100
	250	143,5	1087.1	1991.1	2340	2470	29,5	32228 J/DF
	300	154	1251.2	1787.4	1980	2090	52,5	31328 XJ/DF
150	225	96	770.2	1301.1	2340	2470	13,5	32030 X/DF
	270	154	1236.1	2266.6	2160	2280	37,0	32230 J/DF
	320	164	1404.3	2019.6	1800	1900	58,5	31330 XJ/DF
160	240	102	894.6	1544.2	2160	2280	16,0	32032 X/DF
	290	104	960.1	1444.4	1980	2090	27,5	30232 J/DF
	290	168	1581.4	2777.7	1980	2090	48,0	32232 J/DF
170	230	76	581.4	1143.3	2520	2660	9,20	32934/DFC225
	260	114	1034.6	1811.1	1980	2090	22,0	32034 X/DF
	310	182	1816.2	3229.8	1800	1900	59,0	32234 J/DF
180	250	90	729.7	1443.1	2340	2470	14,0	32936/DF
	280	128	1330	2301	1800	1900	29,5	32036 X/DF
	320	114	1059.2	1611.6	1800	1900	42,0	30236 J/DF
	320	182	1701	3218.6	1710	1805	61,0	32236 J/DF
190	260	90	739.4	1504.6	2160	2280	14,5	32938/DF
	290	128	1350	2379.8	1800	1900	30,5	32038 X/DF
	340	120	1280.6	1981.5	1620	1710	50,0	30238 J/DFC700

CUSCINETTI A RULLI CONICI, AD UNA CORONA, APPAIATI AD "X"
TAPERED ROLLER BEARINGS, SINGLE ROW, FACE-TO-FACE

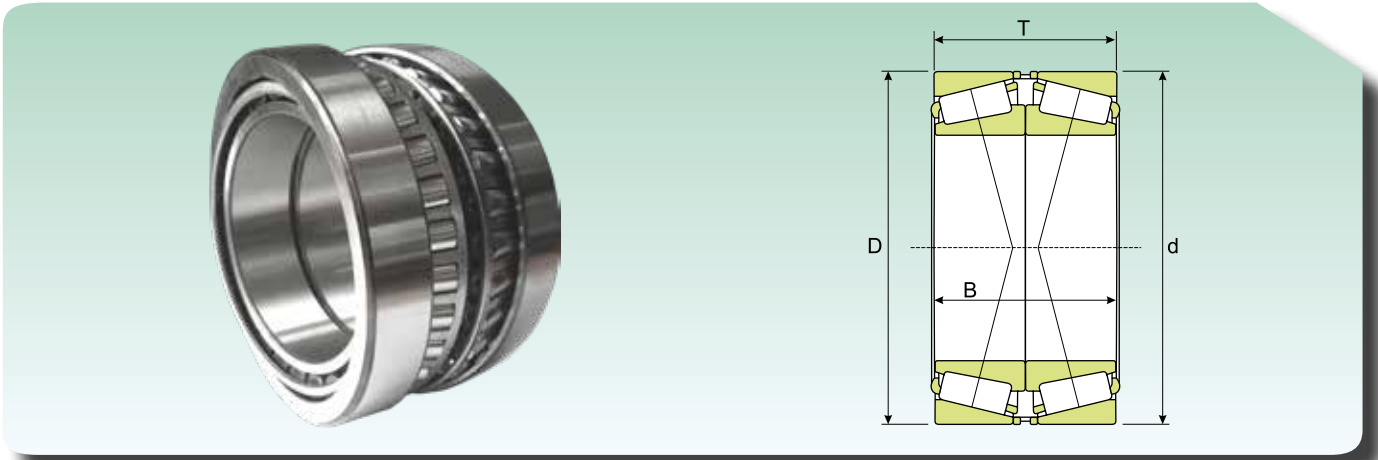

Dimensioni (mm) Dimension (mm)			Coefficiente di carico (kN) Load rating (kN)		Velocità limite (giri/min) Speed limit (Rpm)		Peso (Kg) Weight (Kg)	Sigla Designation
d (mm)	D (mm)	T (mm)	Dinamico Dynamic C	Statico Static C ₀	Lubrificazione Lubrication			
					Grasso Grease	Olio Oil		
200	310	140	1348,8	2716,4	1710	1805	39,0	32040 X/DF
	360	128	1313,2	2195,2	1530	1615	52,0	30240 J/DFC570
	360	208	2199,1	3964,5	1530	1615	88,0	32240 J/DF
	300	102	825,16	1960	1800	1900	21,0	32940/DFC300
	340	152	1509,2	3283	1530	1615	51,0	32040 X/DF
240	360	152	1640,2	3508,1	1440	1520	54,5	32048 X/DF
260	400	174	2089,1	4365,5	1260	1330	79,5	32052 X/DF
280	420	174	2169,4	4711,1	1170	1235	84,5	32056 X/DF
300	420	152	1770,1	4444,6	1260	1330	65,5	32960/DF
320	480	200	2799,6	6147,2	990	1045	125	32064 X/DF

